

ESSENTIALS BY

 DELTALIGHT®

5

TH EDITION
2023-2024



WELCOME TO OUR WORLD



Delta Light specializes in the design and production of architectural lighting, collaborating intimately with architects, designers, contractors, and investors to incorporate lighting into their projects. Since 1989, we have accomplished this through a global network, spanning a diverse array of projects, from residential and retail to office and hospitality environments.

Delta Light specializes in the design and production of architectural lighting, collaborating intimately with architects, designers, contractors, and investors to incorporate lighting into their projects. Since 1989, we have accomplished this through a global network, spanning a diverse array of projects, from residential and retail to office and hospitality environments.

BACK TO THE ESSENTIALS

Essentials by Delta Light® offers well-designed, architectural lighting solutions, for everyone. It combines good design and good functionality with the right quality, at an affordable price.

The Essentials collection is specially developed for the value-oriented customer that is looking for the reliability of a trusted brand, as it complements the Delta Light premium range.

It offers a basic, yet complete selection of interior and exterior, recessed, pendant and surface-mounted luminaires, track lighting and profiles, with quick availability.

It's a cost efficient and complete solution to meet the lighting requirements for different types of projects, with limited finishes and options.

ESSENTIALS A COMPLETE PACKAGE.

The Essentials package allows you to complete a total project: recessed luminaires with a limited built-in depth for either accent or general lighting, a range of surface mounted fixtures to fulfil multiple applications, various pendant luminaires and wall mounted lights to create a certain atmosphere.

With track spots up to 3500lm, different beam angles and even a zoom functionality, all projects are possible.

When browsing the collection, 3 colour codes indicate whether a power supply is included in the fixture, whether it requires an external power supply or no power supply at all. When no power supply is required, the light fixture either operates with LED on mains voltage or GU10 on mains voltage.

 **POWER SUPPLY INCLUSIVE**
 **POWER SUPPLY EXCLUSIVE**
 **NO NEED FOR POWER SUPPLY**

WHAT'S NEW IN THE ESSENTIALS 5 RANGE

SPYCO EXPANDS

The Spyco range has received thoughtful updates in our Essentials 5 catalogue, expanding its versatile lighting solutions within the already established family. The 3-phase track spotlight is now available up to 3500lm and comes with non-dimmable and DALI dimmable versions. Utilizing advanced lenses ensures accurate and refined lighting, with the larger model offering up to three distinct optics for enhanced control and customization of illumination. Choose the optional Honeycomb filter for improved visual comfort. Explore the considerate enhancements of the Spyco range, bringing the right light to your project.

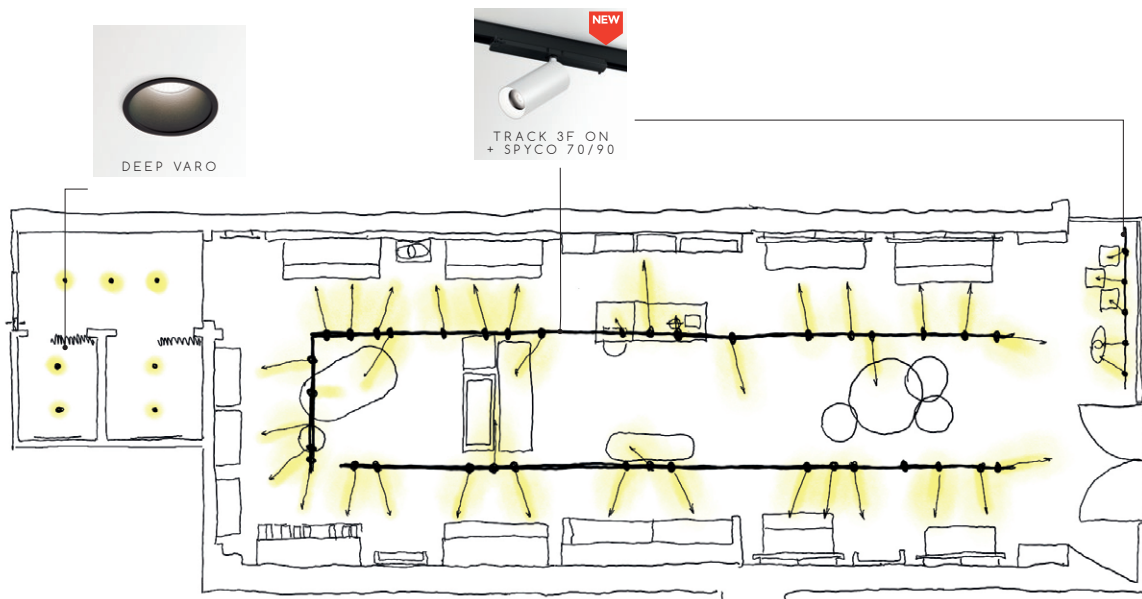

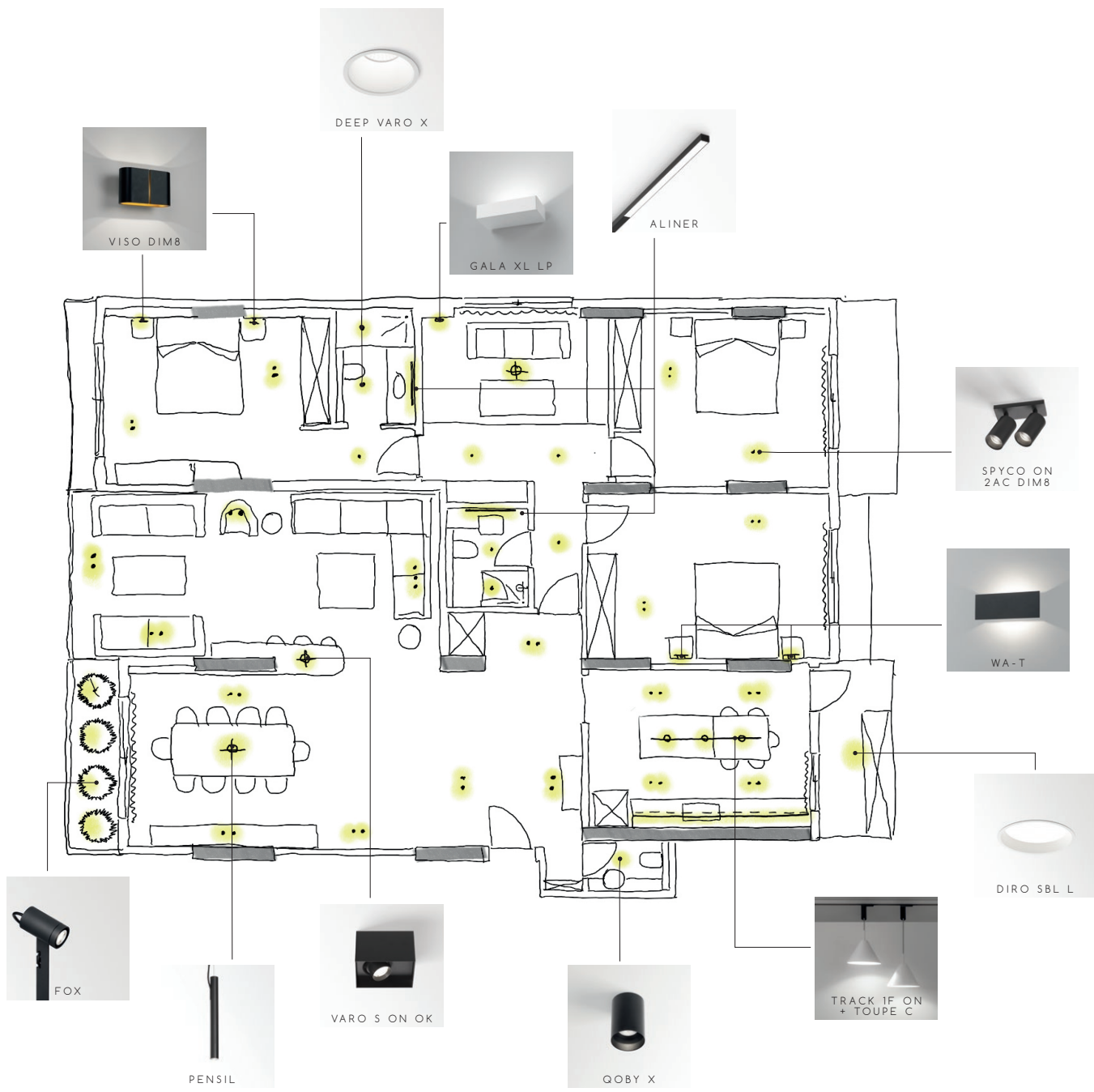

DEEP VARO X



VISO DIM8



GALA XL LP



ALINER



SPYCO ON 2AC DIM8



WA-T



DIRO SBL L



FOX



PENSIL



VARO S ON OK



QOBY X

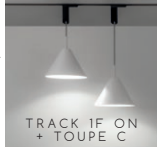

TRACK IF ON + TOUPE C

INTERIOR



PARTOU

7

VARO



9 / 11

VARO L AC



11

DEEP VARO



13



VARO S OK

15



VARO S ON OK

15



DIRO SBL

17



DIRO SBL ON

17



QOBY R

19



QOBY S

19



SPYCO ON

21 / 23 / 25

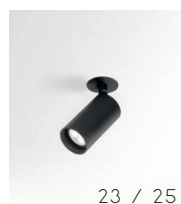

SPYCO CLIP

23 / 25



PENSIL

27



TOUPE

29 / 45 / 55

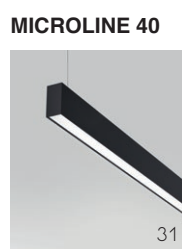

MICROLINE 40

31



ALINER

33



ORBIT T

35

VISO

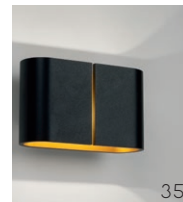

35

WA-T



37

GALA



39



SPYCO ADM

47 / 53



SPYCO 70/90 ADM

49

EXTERIOR



DEEP VARO X

57

VARO X



57

QOBY X R



59

MONO II



61



FOX

63



TIMON

65

LEGENDA	
◇	COLOUR
A	ALU GREY
ANO	ALU ANODIZED
B	BLACK RAL 9005
MMAT	GOLD MAT
N	DARK GREY
W	WHITE RAL 9003
◇	FIXTURE CLASS 1
□	FIXTURE CLASS 2
◇	FIXTURE CLASS 3
0.5	NET WEIGHT KG
IP	PROTECTION LEVEL
⊙	ROUND OPENING DIAMETER x MIN. DEPTH FOR RECESSING
⊞	RECTANGULAR OPENING LENGTH x WIDTH x MINIMUM DEPTH FOR RECESSING
⊞	MAX. THICKNESS OF THE MOUNTING SURFACE
⊞	MIN. DISTANCE (M) LAMP - OBJECT

PARTOU

INTERIOR



MINI PARTOU IP B

PARTOU S IP B



PARTOU IP W



PARTOU OK B

OPTIONS

**INSTALLATION
PLASTERKIT 101
202 11 19**

205 x 205 80 x 180

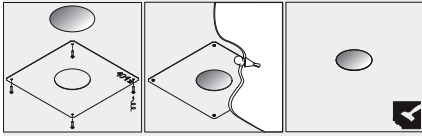

REQUIREMENTS

CONTROL GEAR FULL INFO PAG 80-81

**LED PS 350mA / 15W
300 90 91**

INPUT 110-240V / 50-60Hz
OUTPUT 350mA / 15W / 2-41V-DC

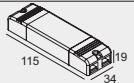

IP20

min.40

**LED PS MULTI-POWER / 10W DIM8
21012 0258**

INPUT 220-240V / 50-60Hz
OUTPUT 350mA / 10W / 16-29V-DC

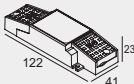

IP20

min.50

**LED PS MULTI-POWER / 15W DIM8
21012 0268**

INPUT 220-240V / 50-60Hz
OUTPUT 350mA / 14.7W / 26-42V-DC

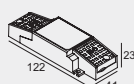

IP20

min.50

**LED PS MULTI-POWER / 20W DIM8
21012 0278**

INPUT 220-240V / 50-60Hz
OUTPUT 500mA / 14W / 15-28V-DC

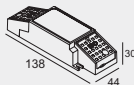

IP20

min.55

**LED PS MULTI-POWER / 36W DIM8
21012 0288**

INPUT 220-240V / 50-60Hz
OUTPUT 500mA / 26W / 30-52V-DC

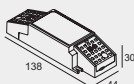

IP20

min.55

**LED PS MULTI-POWER DIM5
300 90 125**

INPUT 110-240V / 50-60Hz
OUTPUT 350mA / 15W / 43V-DC
OUTPUT 500mA / 20W / 5-40V-DC

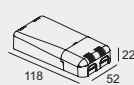

IP20

min.55

**LED PS MULTI-POWER DIM7
300 90 124**

INPUT 110-240V / 50-60Hz
OUTPUT 350mA / 15W / 43V-DC

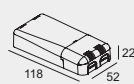

IP20

min.55

#LED [Q]	
350mA	500mA
max.2(1)	-
1	-
2	-
-	1
-	2
max.2	max.2
max.2	max.2

			#LED [Q]	
			350mA	500mA
NON DIM	NON DIMMABLE	300 90 91	max.2(1)	-
FE	DIM 8	21012 0258	1	-
		21012 0268	2	-
		21012 0278	-	1
		21012 0288	-	2
DALI	DIM 5	300 90 125	max.2	max.2
TRV PUSH	DIM 7	300 90 124	max.2	max.2

MINI PARTOU IP

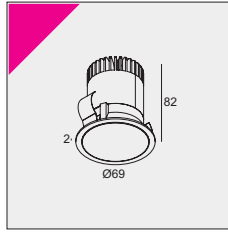

64 x 85 / min. 5

REQUIREMENTS

LED POWER SUPPLY 350-500mA-DC / DIM

3000K / CRI>90	2700K / CRI>90
LED [Q] 6.1W / 775lm / 350mA LED [Q] 9W / 1076lm / 500mA	LED [Q] 6.1W / 768lm / 350mA LED [Q] 9W / 1067lm / 500mA
37°	
25211 9330 ◊	25211 9230 ◊
◊ B-B / W-W	



PARTOU IP

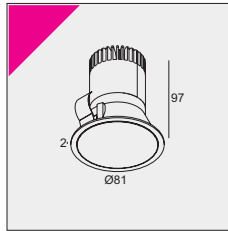

76 x 100 / min. 5

REQUIREMENTS

LED POWER SUPPLY 350-500mA-DC / DIM

OPTIONS

PLASTERKIT 101

3000K / CRI>90	2700K / CRI>90
LED [Q] 6.1W / 775lm / 350mA LED [Q] 9W / 1076lm / 500mA	LED [Q] 6.1W / 768lm / 350mA LED [Q] 9W / 1067lm / 500mA
37°	
25213 9330 ◊	25213 9230 ◊
◊ B-B / W-W	

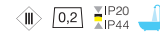

PARTOU OK

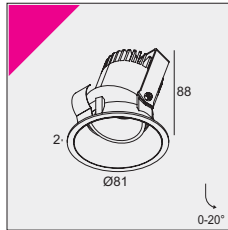

76 x 90 / min. 5

REQUIREMENTS

LED POWER SUPPLY 350-500mA-DC / DIM

OPTIONS

PLASTERKIT 101

3000K / CRI>90	2700K / CRI>90
LED [Q] 6.1W / 775lm / 350mA LED [Q] 9W / 1076lm / 500mA	LED [Q] 6.1W / 768lm / 350mA LED [Q] 9W / 1067lm / 500mA
37°	
25214 9330 ◊	25214 9230 ◊
◊ B-B / W-W	

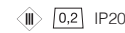

PARTOU S IP

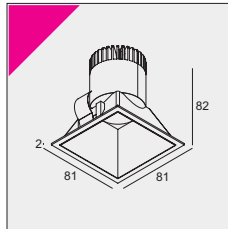

76 x 76 x 100 / min. 5

REQUIREMENTS

LED POWER SUPPLY 350-500mA-DC / DIM

3000K / CRI>90	2700K / CRI>90
LED [Q] 6.1W / 775lm / 350mA LED [Q] 9W / 1076lm / 500mA	LED [Q] 6.1W / 768lm / 350mA LED [Q] 9W / 1067lm / 500mA
37°	
25216 9330 ◊	25216 9230 ◊
◊ B / W	



VARO

INTERIOR



VARO IP W



VARO FLAT W



VARO OK B

OPTIONS

INSTALLATION PLASTERKIT 101 202 11 19



205 x 205

80 x 180

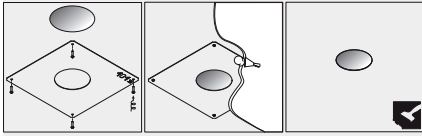

REQUIREMENTS

CONTROL GEAR FULL INFO PAG 80-81

LED PS 350mA / 15W 300 90 91

INPUT 110-240V / 50-60Hz
OUTPUT 350mA / 15W / 2-41V-DC

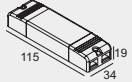

0,2 IP20

min.40

LED PS MULTI-POWER / 10W DIM8 21012 0258

INPUT 220-240V / 50-60Hz
OUTPUT 350mA / 10W / 16-29V-DC

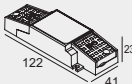

0,1 IP20

min.50

LED PS MULTI-POWER / 15W DIM8 21012 0268

INPUT 220-240V / 50-60Hz
OUTPUT 350mA / 14.7W / 26-42V-DC

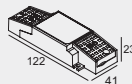

0,2 IP20

min.50

LED PS MULTI-POWER DIM5 300 90 125

INPUT 110-240V / 50-60Hz
OUTPUT 350mA / 15W / 43V-DC

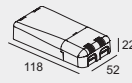

0,1 IP20

min.55

LED PS MULTI-POWER DIM7 300 90 124

INPUT 110-240V / 50-60Hz
OUTPUT 350mA / 15W / 43V-DC



0,1 IP20

min.55

			#LED [H]
	NON DIMMABLE	300 90 91	max.2(1)
	DIM 8	21012 0258	1
		21012 0268	2
	DIM 5	300 90 125	max.2
	DIM 7	300 90 124	max.2

VARO

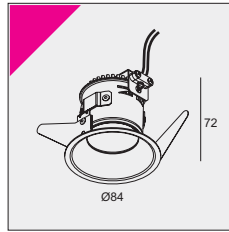

76 x 75 / min.5

REQUIREMENTS
LED POWER SUPPLY 350mA-DC / DIM

OPTIONS
PLASTERKIT 101

3000K / CRI>90	2700K / CRI>90
LED [H] 7.1W / 812lm / 350mA	LED [H] 7.1W / 779lm / 350mA
36°	
423 011 811 932 ◇	423 011 811 922 ◇
◇ B / W	

0,3 IP20

VARO IP

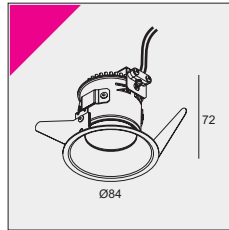

76 x 90 / min.5

REQUIREMENTS
LED POWER SUPPLY 350mA-DC / DIM

OPTIONS
PLASTERKIT 101

3000K / CRI>90	2700K / CRI>90
LED [H] 7.1W / 812lm / 350mA	LED [H] 7.1W / 779lm / 350mA
36°	
423 012 811 932 ◇	423 012 811 922 ◇
◇ B / W	

0,3 IP20 IP44

VARO OK

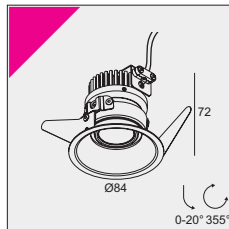

76 x 85 / min.5

REQUIREMENTS
LED POWER SUPPLY 350mA-DC / DIM

OPTIONS
PLASTERKIT 101

3000K / CRI>90	2700K / CRI>90
LED [H] 7.1W / 812lm / 350mA	LED [H] 7.1W / 779lm / 350mA
36°	
423 04 811 932 ◇	423 04 811 922 ◇
◇ B / W	

0,3 IP20

VARO FLAT

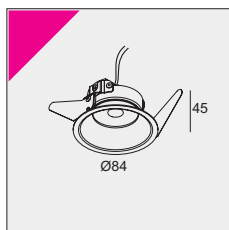

76 x 50 / min.5

REQUIREMENTS
LED POWER SUPPLY 350mA-DC

OPTIONS
PLASTERKIT 101

3000K / CRI>90	2700K / CRI>90
LED [H] 7.1W / 812lm / 350mA	LED [H] 7.1W / 779lm / 350mA
36°	
21917 9320 ◇	21917 9220 ◇
◇ B / W	

0,3 IP20

VARO

INTERIOR



VARO AC W



VARO L AC OK W

OPTIONS

INSTALLATION
PLASTERKIT 101
202 11 19



205 x 205

80 x 180

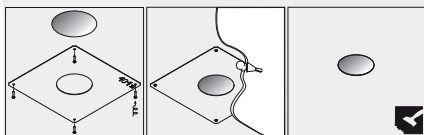

VARO HI

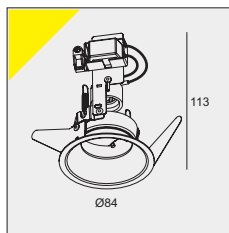

76 x 90 / min.5

OPTIONS
PLASTERKIT 101

QPAR51 max.20W

423 011 00 ◇

◇ B / W

GU10 / 100-240V / 50-60Hz

0,1 IP20 0,5

VARO AC DIM8

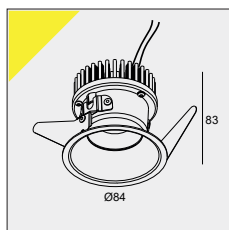

76 x 90 / min.5

OPTIONS
PLASTERKIT 101

3000K / CRI>90

2700K / CRI>90

LED 8W / 630lm

LED 8W / 597lm

33°

MAINS DIMMING (FE)

21918 9328 ◇

21918 9228 ◇

◇ B / W

230V / 50-60Hz

0,3 IP20

VARO L AC OK DIM8

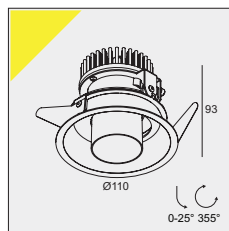

98 x 95 / min.5

3000K / CRI>90

2700K / CRI>90

LED 8W / 630lm

LED 8W / 597lm

33°

MAINS DIMMING (FE)

21929 9328 ◇

21929 9228 ◇

◇ B / W

230V / 50-60Hz

0,3 IP20

DEEP VARO

INTERIOR



OPTIONS

**INSTALLATION
PLASTERKIT 101
202 11 19**

205 x 205 80 x 180

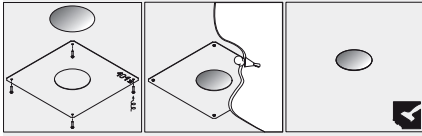

REQUIREMENTS

CONTROL GEAR FULL INFO PAG 80-81

**LED PS 350mA / 15W
300 90 91**

INPUT 110-240V / 50-60Hz
OUTPUT 350mA / 15W / 2-41V-DC

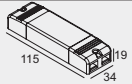

IP20

min.40

**LED PS MULTI-POWER / 10W DIM8
21012 0258**

INPUT 220-240V / 50-60Hz
OUTPUT 350mA / 10W / 16-29V-DC

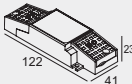

IP20

min.50

**LED PS MULTI-POWER / 15W DIM8
21012 0268**

INPUT 220-240V / 50-60Hz
OUTPUT 350mA / 14.7W / 26-42V-DC

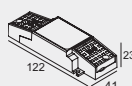

IP20

min.50

**LED PS MULTI-POWER DIM5
300 90 125**

INPUT 110-240V / 50-60Hz
OUTPUT 350mA / 15W / 43V-DC

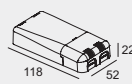

IP20

min.55

**LED PS MULTI-POWER DIM7
300 90 124**

INPUT 110-240V / 50-60Hz
OUTPUT 350mA / 15W / 43V-DC

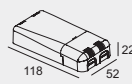

IP20

min.55

			#LED [H]
	NON DIMMABLE	300 90 91	max.2(1)
	DIM 8	21012 0258	1
		21012 0268	2
	DIM 5	300 90 125	max.2
	DIM 7	300 90 124	max.2

DEEP VARO

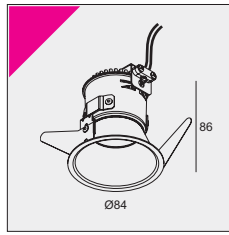

76 x 90 / min.5

REQUIREMENTS

LED POWER SUPPLY 350mA-DC / DIM

OPTIONS

PLASTERKIT 101

3000K / CRI>90	2700K / CRI>90
LED [H] 7.1W / 812lm / 350mA	LED [H] 7.1W / 779lm / 350mA
36°	
423 021 811 932 ◇	423 021 811 922 ◇
◇ B / W	
◇ 0,3 IP20	

DEEP VARO IP

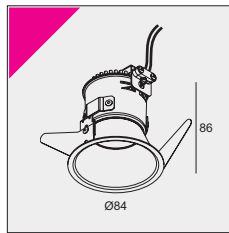

76 x 90 / min.5

REQUIREMENTS

LED POWER SUPPLY 350mA-DC / DIM

OPTIONS

PLASTERKIT 101

3000K / CRI>90	2700K / CRI>90
LED [H] 7.1W / 812lm / 350mA	LED [H] 7.1W / 779lm / 350mA
36°	
423 022 811 932 ◇	423 022 811 922 ◇
◇ B / W	
◇ 0,3 IP20 IP44	

DEEP VARO HI

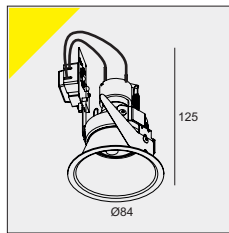

76 x 90 / min.5

OPTIONS

PLASTERKIT 101

QPAR51 max.20W
423 021 00 ◇
◇ B / W
GU10 / 100-240V / 50-60Hz
◇ 0,1 IP20 ◇ 0,5

DEEP VARO AC DIM8

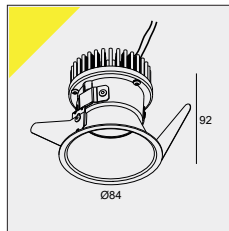

76 x 100 / min.5

OPTIONS

PLASTERKIT 101

3000K / CRI>90	2700K / CRI>90
LED 8W / 630lm	LED 8W / 597lm
33°	
21927 9328 ◇	21927 9228 ◇
◇ B / W	
230V / 50-60Hz	
◇ 0,3 IP20	

VARO S

INTERIOR



VARO 2 S ON OK B



VARO S OK B



VARO S OK B + VARO S COVER MMAT

REQUIREMENTS

CONTROL GEAR FULL INFO PAG 80-81

LED PS 350mA / 15W

300 90 91

INPUT 110-240V / 50-60Hz
OUTPUT 350mA / 15W / 2-41V-DC

0,2 IP20

min.40

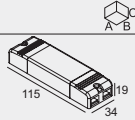

LED PS MULTI-POWER / 10W DIM8

21012 0258

INPUT 220-240V / 50-60Hz
OUTPUT 350mA / 10W / 16-29V-DC

0,1 IP20

min.50

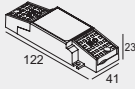

LED PS MULTI-POWER / 15W DIM8

21012 0268

INPUT 220-240V / 50-60Hz
OUTPUT 350mA / 14.7W / 26-42V-DC

0,2 IP20

min.50

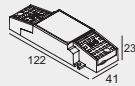

LED PS MULTI-POWER DIM5

300 90 125

INPUT 110-240V / 50-60Hz
OUTPUT 350mA / 15W / 43V-DC

0,1 IP20

min.55

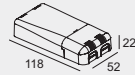

LED PS MULTI-POWER DIM7

300 90 124

INPUT 110-240V / 50-60Hz
OUTPUT 350mA / 15W / 43V-DC

0,1 IP20

min.55

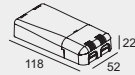

OPTIONS

VARO S COVER

21910 0030 ◊

◊ B / MMAT

0,1

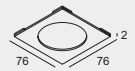

VARO 2 S COVER

21910 0040 ◊

◊ B / MMAT

0,1

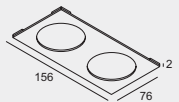

VARO S ON COVER

21910 0010 ◊

◊ B / MMAT

0,1

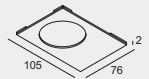

VARO 2 S ON COVER

21910 0020 ◊

◊ B / MMAT

0,1

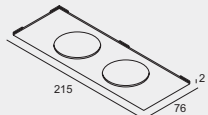

			#LED [U]
	NON DIMMABLE	300 90 91	max.2(1)
	DIM 8	21012 0258 21012 0268	1 2-2
	DIM 5	300 90 125	max.2(2)
	DIM 7	300 90 124	max.3(2)

VARO S OK

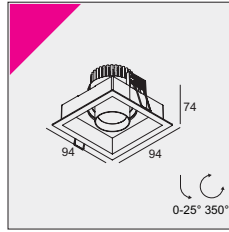

85x85x75 / max.25

REQUIREMENTS

LED POWER SUPPLY 350mA

OPTIONS

VARO S COVER

3000K / CRI>90	2700K / CRI>90
LED [U] 5.8W / 787lm / 350mA	LED [U] 5.8W / 753lm / 350mA
45°	
21932 9320 ◊	21932 9220 ◊
◊ B / W	
0,2 IP20	

VARO 2 S OK

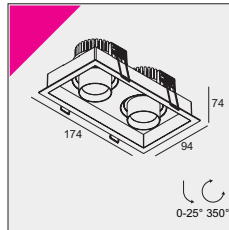

85x165x75 / max.25

REQUIREMENTS

LED POWER SUPPLY 350mA

OPTIONS

VARO 2 S COVER

3000K / CRI>90	2700K / CRI>90
2 x LED [U] 5.8W / 787lm / 350mA	2 x LED [U] 5.8W / 753lm / 350mA
45°	
21933 9320 ◊	21933 9220 ◊
◊ B / W	
0,3 IP20	

VARO S ON OK DIM8

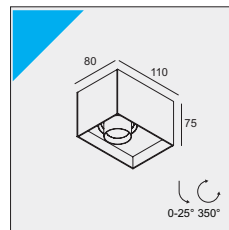

OPTIONS

VARO S ON COVER B

3000K / CRI>90	2700K / CRI>90
5.8W / 787lm / 350mA	5.8W / 753lm / 350mA
45°	
MAINS DIMMING (FE)	
21930 9328 ◊	21930 9228 ◊
◊ B / W	
220-240V / 50-60Hz	
0,6 IP20	

VARO 2 S ON OK DIM8

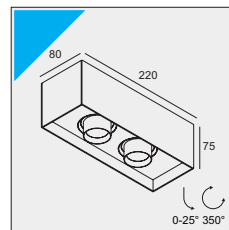

OPTIONS

VARO 2 S ON COVER B

3000K / CRI>90	2700K / CRI>90
2 x 5.8W / 787lm / 350mA	2 x 5.8W / 753lm / 350mA
45°	
MAINS DIMMING (FE)	
21931 9328 ◊	21931 9228 ◊
◊ B / W	
220-240V / 50-60Hz	
1,0 IP20	

DIRO SBL

INTERIOR



DIRO SBL M W



DIRO SBL S ON W + DIRO SBL L ON W

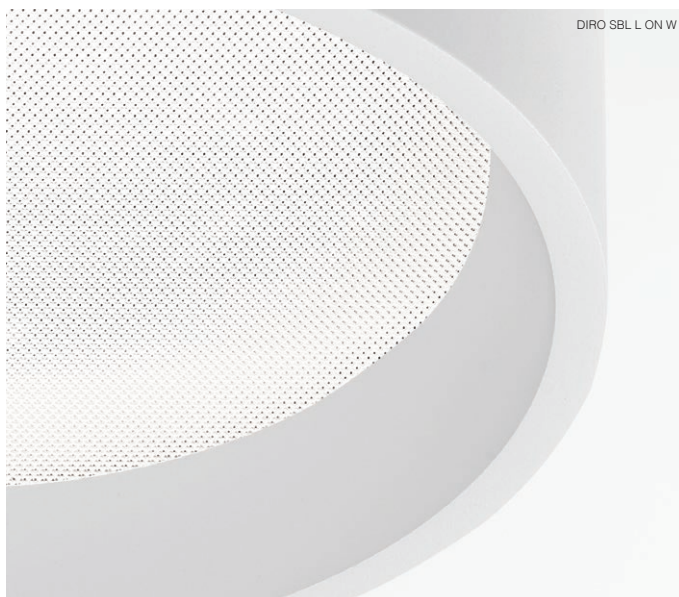

DIRO SBL L ON W

DIRO SBL S IP

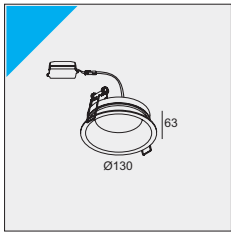

121 x 65 / max.25

3000K / CRI>80	2700K / CRI>80
CLUSTER 6.1W / 882lm / 350mA	
11436 8300 ◇	11436 8200 ◇
◇ W	
100-240V / 50-60Hz	
<input type="checkbox"/> 0,5 <input type="checkbox"/> IP20 <input type="checkbox"/> IP44	

DIRO SBL M

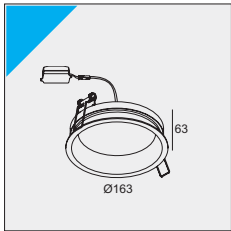

156 x 70 / max.25

3000K / CRI>80	2700K / CRI>80
CLUSTER 9.8W / 1500lm / 350mA	
202 296 83 ◇	202 296 82 ◇
◇ B / W	◇ W
100-240V / 50-60Hz	
<input type="checkbox"/> 0,6 <input type="checkbox"/> IP20 <input type="checkbox"/> IP43	

DIRO SBL L

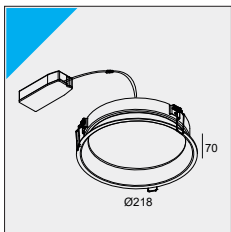

208 x 75 / max.25

3000K / CRI>90	2700K / CRI>90
CLUSTER 18.1W / 2288lm / 1050mA	CLUSTER 18.1W / 2281lm / 1050mA
11437 9300 ◇	11437 9200 ◇
◇ B / W	◇ W
100-240V / 50-60Hz	
<input type="checkbox"/> 0,8 <input type="checkbox"/> IP20 <input type="checkbox"/> IP43	

DIRO SBL S ON

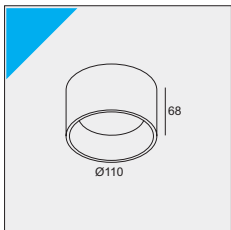

121 x 65 / max.25

3000K / CRI>80	2700K / CRI>80
CLUSTER 6.1W / 882lm / 350mA	
251 77 83 ◇	251 77 82 ◇
◇ B / W	◇ W
100-240V / 50-60Hz	
<input type="checkbox"/> 0,7 IP43	

DIRO SBL S ON IP

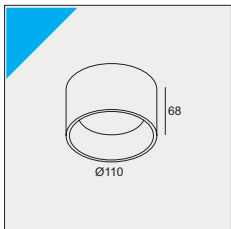

121 x 65 / max.25

3000K / CRI>80	2700K / CRI>80
CLUSTER 6.1W / 882lm / 350mA	
11435 8300 ◇	11435 8200 ◇
◇ W	
100-240V / 50-60Hz	
<input type="checkbox"/> 0,7 IP44	

DIRO SBL L ON

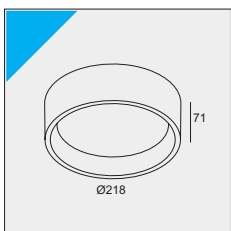

208 x 75 / max.25

3000K / CRI>80	2700K / CRI>80
CLUSTER 17.5W / 2635lm / 1050mA	
251 81 83 ◇	251 81 82 ◇
◇ B / W	◇ W
100-240V / 50-60Hz	
<input type="checkbox"/> 1,7 IP43	

QOBY

INTERIOR

QOBY R HI B + QOBY TUBE MMAT

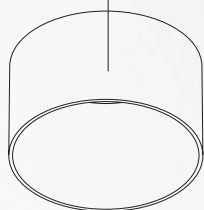

FINISH YOUR QOBY WITH
THE QOBY TUBE IN BLACK, GOLD OR WHITE.



QOBY R HI B + QOBY TUBE MMAT

QOBY S AC 2 DIM8 B + 2 X QOBY TUBE MMAT



ACCESSOIRES

QOBY TUBE
28310 0010 ◊
 ◊ B / W / MMAT



0,1

QOBY R HI

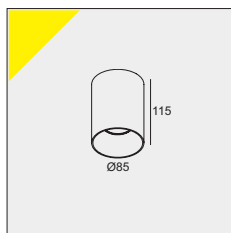

1 x QPAR51 max.20W

19121 0000 ◊

◊ B / W

GU10 / 100-240V / 50-60Hz

◊ 0,2 IP20

QOBY R AC DIM8

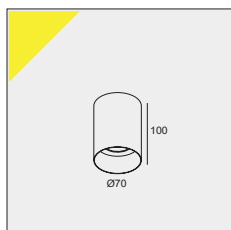

3000K / CRI>90

2700K / CRI>90

LED 8W / 630lm

LED 8W / 597lm

33°

MAINS DIMMING (FE)

28311 9328 ◊

28311 9228 ◊

◊ B / W

230V / 50-60Hz

◊ 0,4 IP20

ACCESSOIRES
 QOBY TUBE

QOBY S AC 1 DIM8

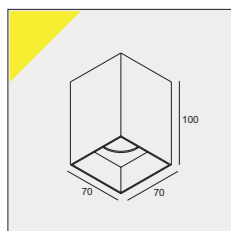

3000K / CRI>90

2700K / CRI>90

LED 8W / 630lm

LED 8W / 597lm

33°

MAINS DIMMING (FE)

28312 9328 ◊

28312 9228 ◊

◊ B / W

230V / 50-60Hz

◊ 0,4 IP20

ACCESSOIRES
 QOBY TUBE

QOBY S AC 2 DIM8

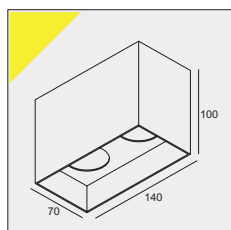

3000K / CRI>90

2700K / CRI>90

2 x LED 8W / 630lm

2 x LED 8W / 597lm

33°

MAINS DIMMING (FE)

28313 9328 ◊

28313 9228 ◊

◊ B / W

230V / 50-60Hz

◊ 0,7 IP20

ACCESSOIRES
 QOBY TUBE

SPYCO

INTERIOR

SPYCO ON 1 DIM8 B



SPYCO ON 2 B



SPYCO ON 3 DIM8 B

REQUIREMENTS

SPY TUBE S
414 02 00 ◊
 ◊ B / W / MMAT
 0,1



SPYCO ON 1 DIM8

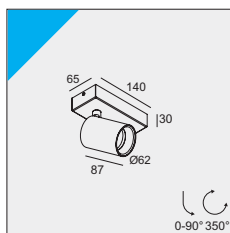

REQUIREMENTS
 SPY TUBE S

3000K / CRI>90	2700K / CRI>90
LED 7.1W / 812lm / 350mA	LED 7.1W / 779lm / 350mA
33°	
MAINS DIMMING (FE)	
414 353 811 932 ED8 ◊	414 353 811 922 ED8 ◊
◊ B / W	
220-240V / 50-60Hz	
□ 0,8 IP20	

SPYCO ON 2 DIM8

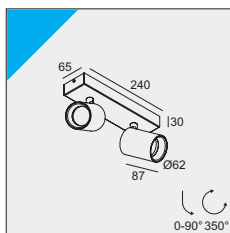

REQUIREMENTS
 2 x SPY TUBE S

3000K / CRI>90	2700K / CRI>90
2 x LED 7.1W / 812lm / 350mA	2 x LED 7.1W / 779lm / 350mA
33°	
MAINS DIMMING (FE)	
414 353 812 932 ED8 ◊	414 353 812 922 ED8 ◊
◊ B / W	
220-240V / 50-60Hz	
□ 1,2 IP20	

SPYCO ON 3 DIM8

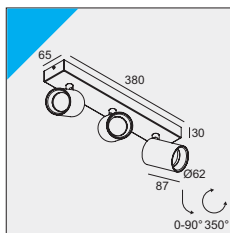

REQUIREMENTS
 3 x SPY TUBE S

3000K / CRI>90	2700K / CRI>90
3 x LED 7.1W / 812lm / 350mA	3 x LED 7.1W / 779lm / 350mA
33°	
MAINS DIMMING (FE)	
414 353 813 932 ED8 ◊	414 353 813 922 ED8 ◊
◊ B / W	
220-240V / 50-60Hz	
□ 1,9 IP20	

SPYCO AC

INTERIOR



SPYCO CLIP AC DIM8 B

SPYCO ON AC DIM8 B



SPYCO ON 3 AC DIM8 B



ACCESSOIRES

SPY TUBE S
414 02 00 ◊
 ◊ B / W / MMAT
 0,1



SPYCO CLIP AC DIM8

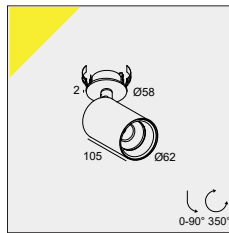

50 x 40
ACCESSOIRES
 SPY TUBE S

3000K / CRI>90	2700K / CRI>90
8W / 630lm	8W / 597lm
33°	
MAINS DIMMING (FE)	
19918 9328 ◊	19918 9228 ◊
◊ B / W (incl. SPY TUBE S)	
230V / 50-60Hz	
◊ 0,4 IP20	

SPYCO ON AC DIM8

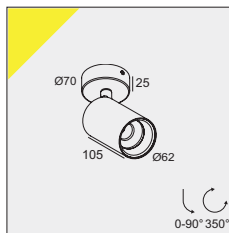

ACCESSOIRES
 SPY TUBE S

3000K / CRI>90	2700K / CRI>90
LED 8W / 630lm	LED 8W / 597lm
33°	
MAINS DIMMING (FE)	
19919 9328 ◊	19919 9228 ◊
◊ B / W (incl. SPY TUBE S)	
230V / 50-60Hz	
◊ 0,4 IP20	

SPYCO ON 1 AC DIM 8

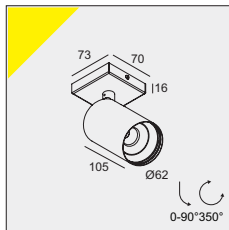

ACCESSOIRES
 SPY TUBE S

3000K / CRI>90	2700K / CRI>90
8W / 630lm	8W / 597lm
33°	
MAINS DIMMING (FE)	
28314 9328 ◊	28314 9228 ◊
◊ B / W (incl. SPY TUBE S)	
230V / 50-60Hz	
◊ 0,4 IP20	

SPYCO ON 2 AC DIM 8

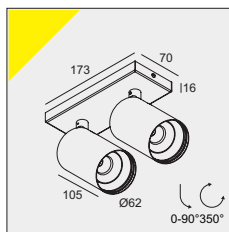

ACCESSOIRES
 SPY TUBE S

3000K / CRI>90	2700K / CRI>90
2 x 8W / 630lm	2 x 8W / 597lm
33°	
MAINS DIMMING (FE)	
28315 9328 ◊	28315 9228 ◊
◊ B / W (incl. SPY TUBE S)	
230V / 50-60Hz	
◊ 0,7 IP20	

SPYCO ON 3 AC DIM 8

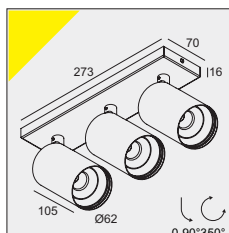

ACCESSOIRES
 SPY TUBE S

3000K / CRI>90	2700K / CRI>90
3 x 8W / 630lm	3 x 8W / 597lm
33°	
MAINS DIMMING (FE)	
28316 9328 ◊	28316 9228 ◊
◊ B / W (incl. SPY TUBE S)	
230V / 50-60Hz	
◊ 1,1 IP20	

SPYCO HI

INTERIOR

SPYCO CLIP HI B



SPYCO ON 1 HI W

SPYCO ON 2 HI B



SPYCO CLIP HI

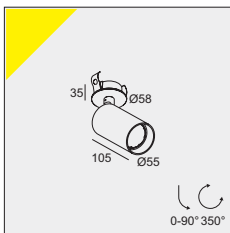

50 x 40

1 x QPAR51 max.20W

414 353 00 ◇

◇ B / W

220-240V / 50-60Hz

□ **0.8** IP20

SPYCO ON 1 HI

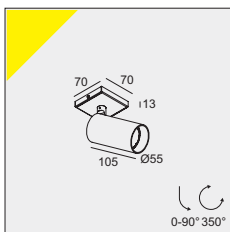

1 x QPAR51 max.20W

414 353 10 ◇

◇ B / W

220-240V / 50-60Hz

□ **0.8** IP20

SPYCO ON 2 HI

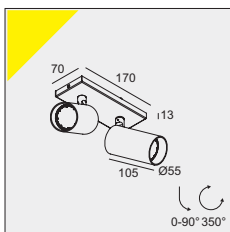

2 x QPAR51 max.20W

414 353 20 ◇

◇ B / W

220-240V / 50-60Hz

□ **1.2** IP20

SPYCO ON 3 HI

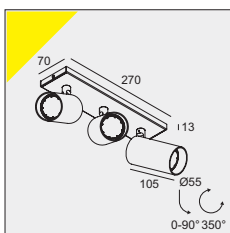

3 x QPAR51 max.20W

414 353 30 ◇

◇ B / W

220-240V / 50-60Hz

□ **1.9** IP20

PENSIL

INTERIOR

PENSIL DIM8 B



PENSIL DIM8

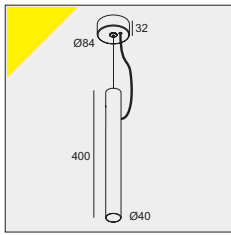

3000K / CRI>90	2700K / CRI>90
5.8W / 787lm / 350mA	5.8W / 753lm / 350mA
36°	
MAINS DIMMING (FE)	
28610 9328 ◇	28610 9228 ◇
◇ B / W	
220-240V / 50-60Hz	
INCL. 1 x CABLE 2 x 0.75mm ² 1.6m	

◇ **0,8** IP20

TOUPE

INTERIOR



TOUPE C E27 B + TOUPE SHADE L
TOUPE C E27 W + TOUPE SHADE M

REQUIREMENTS

TOUPE SHADE S

28700 0010

◇ B / W

0,3



TOUPE SHADE M

28700 0030

◇ B / W

1,0

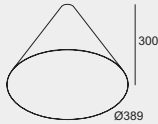

TOUPE SHADE L

28700 0020

◇ B / W

2,3

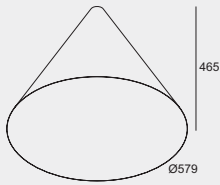

CEILING BASE MULTI 1

28700 0040

◇ B / W

0,2



CEILING BASE MULTI 3

28700 0070

◇ B / W

0,2

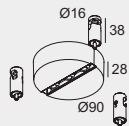

OPTIONS

LED FILAMENT LAMPS E27

A60 E27 6W 2700K ●

21024 0120

CRI>80 / 670lm / 6W

NON DIMMABLE

220-240V / 50-60Hz

0,1 IP20



A60 E27 6W 2200K ● - MIST

21024 0130

CRI>90 / 500lm / 6W

MAINS DIMMING (FE)

220-240V / 50-60Hz

0,1 IP20



CABLE CLAMP

15229 0010

◇ B

0,1



TOUPE C AC DIM8

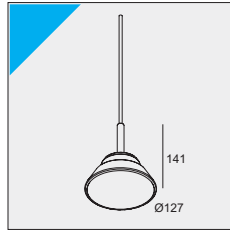

REQUIREMENTS

TOUPE SHADE S / M / L

CEILING BASE MULTI 1 OR MULTI 3

OPTIONS

CABLE CLAMP

3000K / CRI>90	2700K / CRI>90
8W / 630lm	8W / 597lm
MAINS DIMMING (FE)	
28710 9308 ◇	28710 9208 ◇
◇ B / W	
230V / 50-60Hz	
INCL. 1 x CABLE 3 x 0.75mm ² 1.6m	

◇ 0,3 IP20

TOUPE C E27

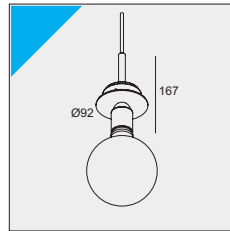

REQUIREMENTS

TOUPE SHADE M / L

CEILING BASE MULTI 1 OR MULTI 3

OPTIONS

CABLE CLAMP
LED FILAMENT LAMP E27

1 x A60 max.20W
28712 0000 ◇
◇ B / W
E27 / 100-240V / 50-60Hz
INCL. 1 x CABLE 3 x 0.75mm ² 1.6m

◇ 0,3 IP20

MICROLINE 40

INTERIOR



MICROLINE 40 P2483 W



MICROLINE 40 P2483 B + SUSPENSION SET 27

OPTIONS

INSTALLATION



SUSPENSION SET 27 1.6m

328 27 22 ◊

◊ = B / W

INCL. 2 x CABLE SUSPENSION SINGLE AUTO. 1.6m

INCL. 1 x CABLE 3 x 0.75mm²

INCL. 1 x CABLE BASE S - B / W



MICROLINE 40 P2483

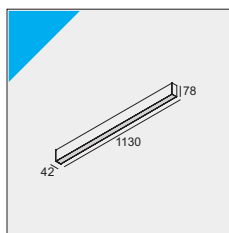

OPTIONS

SUSPENSION SET 27 ◊ ▶ 328 27 22 B / W

3000K / CRI>90

CLUSTER 24W / 4060lm / 700mA

399 011 24 E ◊

◊ B / W

220-240V / 50-60Hz

◊ 1,8 IP20

MICROLINE 40 P3683

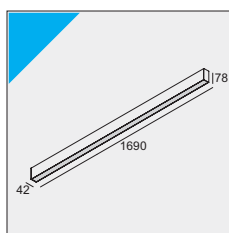

OPTIONS

SUSPENSION SET 27 ◊ ▶ 328 27 22 B / W

3000K / CRI>90

CLUSTER 36W / 6088lm / 700mA

399 011 36 E ◊

◊ B / W

220-240V / 50-60Hz

◊ 2,5 IP20

ALINER

INTERIOR



ALINER 125 B

ALINER 125

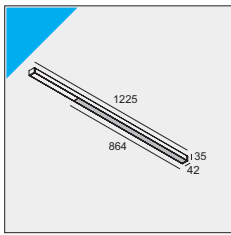

3000K / CRI>90

25.5W / 3450lm / 250mA

27411 9300 ◇

◇ B / W

220-240V / 50-60Hz

◇ **0,9** IP20

VISO

INTERIOR



VISO DIM8 B-MMAT

VISO DIM8 W-W



ORBIT

ORBIT T W-W

ORBIT B-MMAT



VISO DIM8

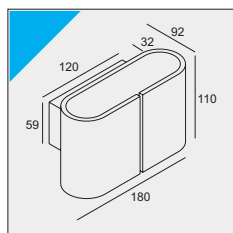

3000K / CRI>90	2700K / CRI>90
2 x 5W / 462lm / 500mA	2 x 5W / 433lm / 500mA
MAINS DIMMING (FE)	
275 07 93 ED8 ◇	275 07 92 ED8 ◇
◇ B-MMAT / W-W	
220-240V / 50-60Hz	
◇ 1.0 IP20	

ORBIT T

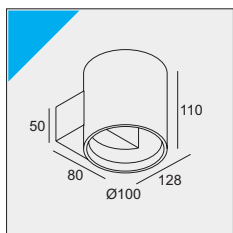

3000K / CRI>90	2700K / CRI>90
3W / 484lm / 24V-DC	
271 05 93 ◇	271 05 92 ◇
◇ B-MMAT / W-W	
220-240V / 50-60Hz	
◇ 0.6 IP20	

WA-T

INTERIOR

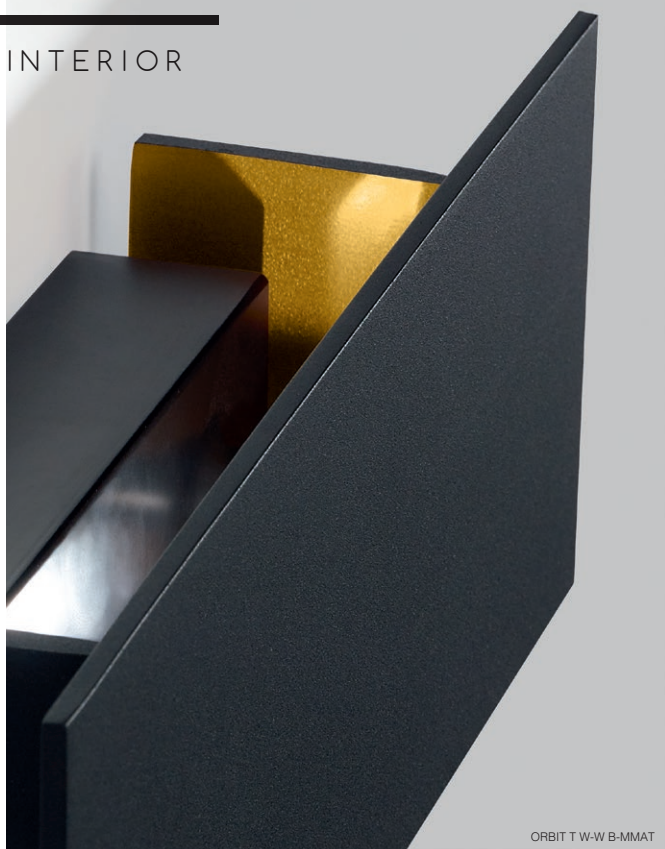

WA - T

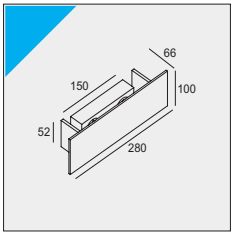

3000K / CRI>90	3000-2000K / CRI>90
LED 7,5W / 700lm / 500mA	LED 9W / 690lm / 250mA
NON DIM	MAINS DIMMING (FE)
275 15 93 ◇	275 15 1902 ED8 ◇
◇ B-MMAT / W-W	
110-240V / 50-60Hz	110-240V / 50-60Hz

◇ 0,9 IP20

GALA

INTERIOR



GALA T W



GALA XL LP DIM8 W

GALA T

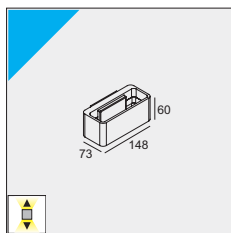

3000K / CRI>90	2700K / CRI>90
LED CLUSTER 9.4W / 1479lm / 350mA	LED CLUSTER 9.4W / 1422lm / 350mA
12220 9300 ◇	12220 9200 ◇
◇ W	
220-240V / 50-60Hz	
□ 0,5 IP20	

GALA XL LP DIM8

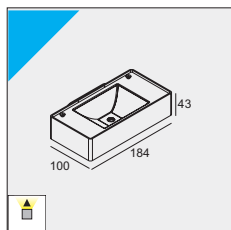

3000K / CRI>90	2700K / CRI>90
7.1W / 812lm / 350mA	7.1W / 779lm / 350mA
MAINS DIMMING (FE)	
12219 9308 ◇	12219 9208 ◇
◇ W	
220-240V / 50-60Hz	
◇ 0,8 IP20	

TRACK 3F DIM ON

COMPOSITION

- 1 TRACK 3F DIM ON
- 2 ENDCAP / SUPPLY / CORNERS
- 3 FIXATION
- 4 CURRENT SUPPLY
- 5 ACCESSORIES
- 6 OPTIONS

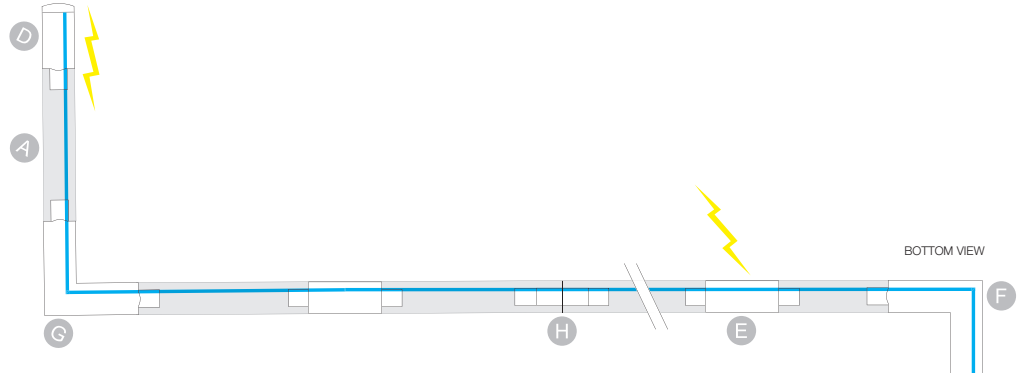

1 TRACK

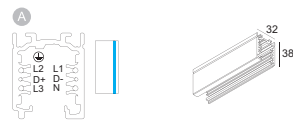

TRACK 3F DIM ON 1m ◇
200 12 410 ◇
 ◇ = B / W (RAL 9010)
 110-240V / 50-60Hz / 3F
 ⚡ IP20
 0,8

TRACK 3F DIM ON 2m ◇
200 12 420 ◇
 ◇ = B / W (RAL 9010)
 110-240V / 50-60Hz / 3F
 ⚡ IP20
 1,6

TRACK 3F DIM ON 3m ◇
200 12 430 ◇
 ◇ = B / W (RAL 9010)
 110-240V / 50-60Hz / 3F
 ⚡ IP20
 2,4

2 ENDCAP / SUPPLY / CORNERS



TRACK ON END CAP ◇
200 12 41 ◇
 ◇ = B / W (RAL 9010)
 0,1

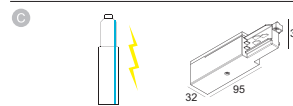

TRACK END SUPPLY 11 ◇
200 12 11 ◇
 ◇ = B / W (RAL 9010)
 110-240V / 50-60Hz
 ⚡ IP20
 0,1

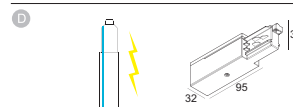

TRACK END SUPPLY 12 ◇
200 12 12 ◇
 ◇ = B / W (RAL 9010)
 110-240V / 50-60Hz
 ⚡ IP20
 0,1

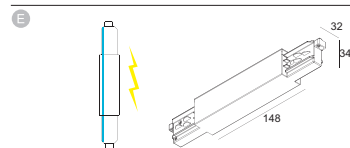

TRACK MIDDLE SUPPLY ◇
200 12 14 ◇
 ◇ = B / W (RAL 9010)
 110-240V / 50-60Hz
 ⚡ IP20
 0,1

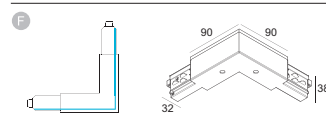

TRACK CORNER 90° OUT ◇
200 12 35 ◇
 ◇ = B / W (RAL 9010)
 ⚡ IP20
 0,1

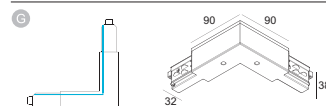

TRACK CORNER 90° IN ◇
200 12 34 ◇
 ◇ = B / W (RAL 9010)
 ⚡ IP20
 0,1

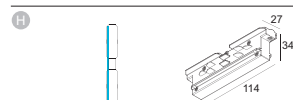

TRACK CORNER 180° ◇
200 12 21 ◇
 ◇ = B / W (RAL 9010)
 ⚡ IP20
 0,1

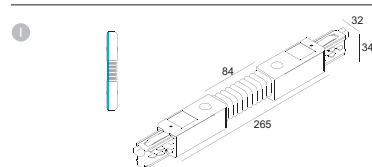

TRACK FLEX CORNER ◇
200 12 24 ◇
 ◇ = B / W (RAL 9010)
 ⚡ IP20
 0,1
 FLEXIBLE 60° - 300°

3 FIXATION

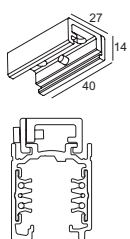

TRACK DIM ON DIRECT FIXATION ◇
200 12 02 ◇
 ◇ = ANO
0,1

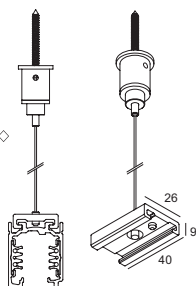

TRACK DIM ON SUSPENSION 3.0
200 12 13
L 3.0m
0,1

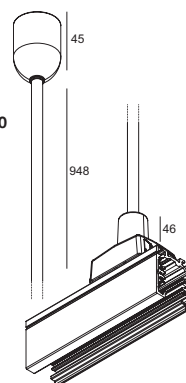

TRACK DIM ON ROD SUSPENSION 1.0
200 12 50 ◇
 ◇ = B / W
L 948mm
0,1

4 CURRENT SUPPLY

TRACK CURRENT SUPPLY 5 x 0.75mm² 3.0m
200 99 53
 L 3.0m / 5 x 0.75mm²



OPTIONS
 CABLE BASE R/S

0,3

5 ACCESSORIES

TRACK CUTTING TOOL
200 12 01

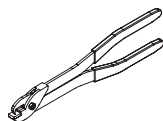

0,2

6 OPTIONS

INSTALLATION

CABLE BASE R ◇

203 99 55 ◇

◇ = B / W



Ø57 x 41



CABLE BASE S ◇

203 99 56 ◇

◇ = B / W

57 x 57 x 41



COVERSET R ◇

204 00 100 ◇

◇ = B / W

Ø100



TRACK 3F ON

COMPOSITION

- 1 TRACK 3F ON
- 2 ENDCAP / SUPPLY / CORNERS
- 3 FIXATION
- 4 CURRENT SUPPLY
- 5 OPTIONS

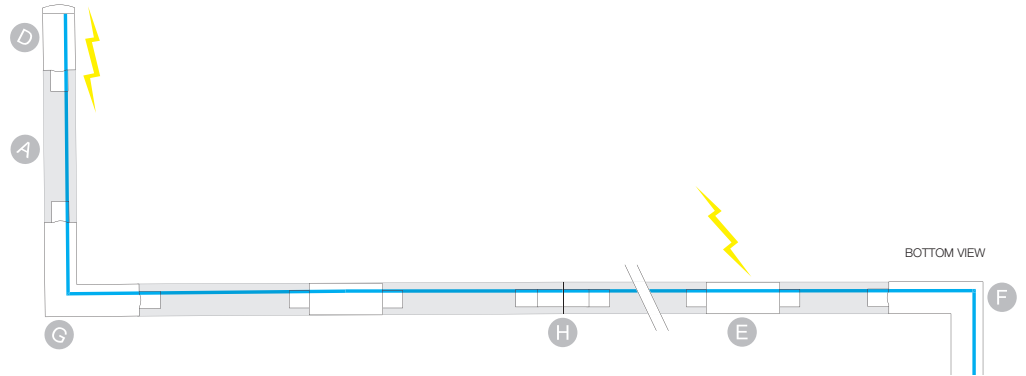

1 TRACK

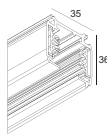
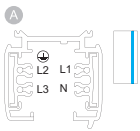

TRACK 3F ON 2m ◇
28900 0020 ◇
 ◇ = B / W (RAL 9010)
 110-240V / 50-60Hz / 3F
 ◇ IP20
 1,8

TRACK 3F ON 3m ◇
28900 0030 ◇
 ◇ = B / W (RAL 9010)
 110-240V / 50-60Hz / 3F
 ◇ IP20
 2,7

2 ENDCAP / SUPPLY / CORNERS

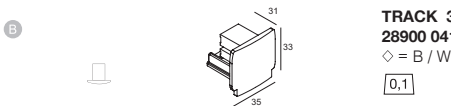

TRACK 3F ON END CAP ◇
28900 0410 ◇
 ◇ = B / W (RAL 9010)
 0,1

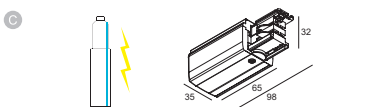

TRACK 3F ON END SUPPLY 11 ◇
28900 0110 ◇
 ◇ = B / W (RAL 9010)
 110-240V / 50-60Hz
 ◇ 0,1 IP20

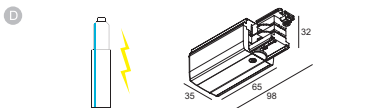

TRACK 3F ON END SUPPLY 12 ◇
28900 0120 ◇
 ◇ = B / W (RAL 9010)
 110-240V / 50-60Hz
 ◇ 0,1 IP20

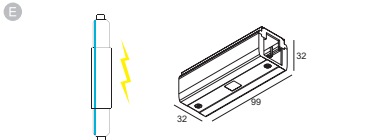

TRACK 3F ON MIDDLE SUPPLY ◇
28900 0140 ◇
 ◇ = B / W (RAL 9010)
 110-240V / 50-60Hz
 ◇ 0,2 IP20

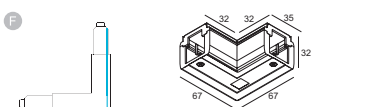

TRACK 3F ON CORNER 90° OUT ◇
28900 0350 ◇
 ◇ = B / W (RAL 9010)
 110-240V / 50-60Hz
 ◇ 0,2 IP20

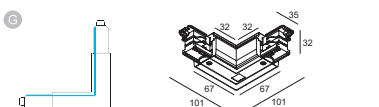

TRACK 3F ON CORNER 90° IN ◇
28900 0340 ◇
 ◇ = B / W (RAL 9010)
 110-240V / 50-60Hz
 ◇ 0,2 IP20

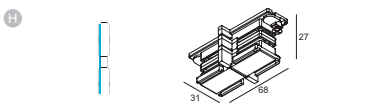

TRACK 3F ON CORNER 180° ◇
28900 0210 ◇
 ◇ = B / W (RAL 9010)
 ◇ 0,2 IP20

3 FIXATION

TRACK 3F ON DIRECT FIXATION ◇
28900 0400 ◇
 ◇ = B/W
 0,1

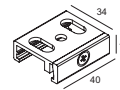
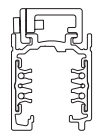
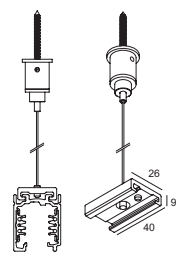
TRACK 3F ON SUSPENSION 3.0 ◇
28900 0420 ◇
L 3.0m
 ◇ = B/W
 0,1



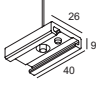

4 CURRENT SUPPLY

TRACK CURRENT SUPPLY 5 x 0.75mm² 3.0m
200 99 53
 L 3.0m / 5 x 0.75mm²
 OPTIONS
 CABLE BASE R/S
 0,3



5 OPTIONS

- INSTALLATION**
- | | | |
|---|--------------|---|
| CABLE BASE R ◇
203 99 55 ◇
◇ = B / W | Ø57 x 41 |  |
| CABLE BASE S ◇
203 99 56 ◇
◇ = B / W | 57 x 57 x 41 |  |
| COVERSET R ◇
204 00 100 ◇
◇ = B / W | Ø100 |  |

TOUPE

INTERIOR



TOUPE C E27 + TOUPE SHADE L + CABLE CLAMP
TOUPE C E27 + TOUPE SHADE M

REQUIREMENTS

TOUPE SHADE S

28700 0010

◇ B / W

0,3



TOUPE SHADE M

28700 0030

◇ B / W

1,0

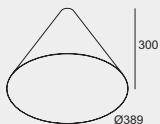

TOUPE SHADE L

28700 0020

◇ B / W

2,3

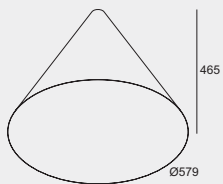

OPTIONS

LED FILAMENT LAMPS E27

A60 E27 6W 2700K ●
21024 0120
 CRI>80 / 670lm / 6W
 NON DIMMABLE
 220-240V / 50-60Hz

0,1 IP20



A60 E27 6W 2200K ● - MIST
21024 0130
 CRI>90 / 500lm / 6W
 MAINS DIMMING (FE)
 220-240V / 50-60Hz

0,1 IP20



CABLE CLAMP
15229 0010

◇ B

0,1



TOUPE C AC DIM8

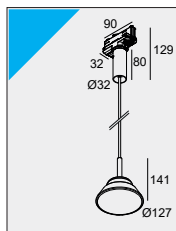

REQUIREMENTS

TOUPE SHADE S / M / L
 TRACK 3F ON OR TRACK 3F DIM ON

OPTIONS

CABLE CLAMP

3000K / CRI>90	2700K / CRI>90
8W / 630lm	8W / 597lm
MAINS DIMMING (FE)	
100061 9308 ◇	100061 9208 ◇
◇ B / W	
230V / 50-60Hz	
INCL. 1 x CABLE 3 x 0.75mm ² 1.6m	

◇ 0,6 IP20

TOUPE C E27

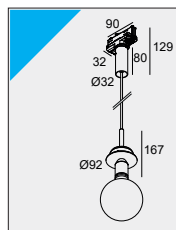

REQUIREMENTS

TOUPE SHADE M / L
 TRACK 3F ON OR TRACK 3F DIM ON

OPTIONS

CABLE CLAMP
 LED FILAMENT LAMP E27

1 x A60 max.20W
100063 0000 ◇
◇ B / W
E27 / 100-240V / 50-60Hz
INCL. 1 x CABLE 3 x 0.75mm ² 1.6m

◇ 0,6 IP20

SPYCO ADM

INTERIOR



SPYCO HI ADM B



SPYCO HI ADM W

ACCESSOIRES

SPY TUBE S
414 02 00 ◊
 ◊ B / W / MMAT
 [0,1]



SPYCO HI ADM

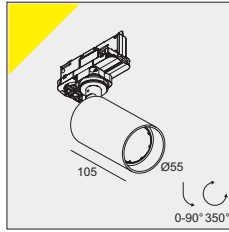

REQUIREMENTS
 TRACK 3F ON OR TRACK 3F DIM ON

1 x QPAR51 max.20W

414 353 10 ADM ◊

◊ B / W

220-240V / 50-60Hz

◊ [0,8] IP20

SPYCO AC ADM DIM8

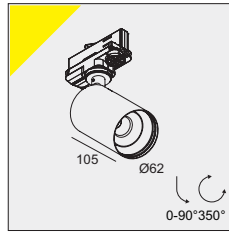

REQUIREMENTS
 TRACK 3F ON OR TRACK 3F DIM ON
ACCESSORIES
 SPY TUBE S

3000K / CRI>90

2700K / CRI>90

8W / 630lm

8W / 597lm

33°

MAINS DIMMING (FE)

28317 9328 ◊

28317 9228 ◊

◊ B / W (incl. SPY TUBE S)

230V / 50-60Hz

◊ [1,1] IP20

SPYCO 70/90 ADM

INTERIOR



SPYCO 70 ADM

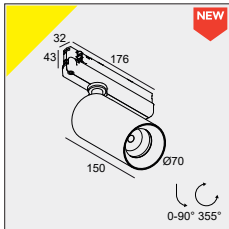

REQUIREMENTS
TRACK 3F ON
OR TRACK 3F DIM ON

NON DIM			
4000K / CRI>90		3000K / CRI>90	
LED 17.2W / 2222lm / 500mA-DC		LED 17.2W / 2101lm / 500mA-DC	
+HONEYCOMB 70: LED 15.3W / 2024lm / 450mA-DC		+HONEYCOMB 70: LED 15.3W / 1913lm / 450mA-DC	
24°	36°	24°	36°
19920 9420 ◇	19920 9430 ◇	19920 9320 ◇	19920 9330 ◇
◇ B / W			
220-240V / 50-60Hz			
◇ 0,6 IP20			

SPYCO 70 ADM DIM 5

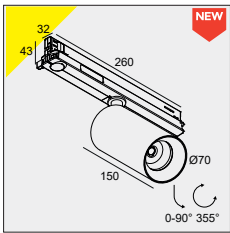

REQUIREMENTS
TRACK 3F DIM ON

DIMMING BY DALI			
4000K / CRI>90		3000K / CRI>90	
LED 17.2W / 2222lm / 500mA-DC		LED 17.2W / 2101lm / 500mA-DC	
+HONEYCOMB 70: LED 15.3W / 2024lm / 450mA-DC		+HONEYCOMB 70: LED 15.3W / 1913lm / 450mA-DC	
24°	36°	24°	36°
19920 9425 ◇	19920 9435 ◇	19920 9325 ◇	19920 9335 ◇
◇ B / W			
220-240V / 50-60Hz			
◇ 0,6 IP20			

SPYCO 90 ADM

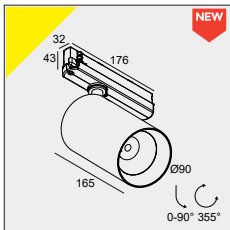

REQUIREMENTS
TRACK 3F ON
OR TRACK 3F DIM ON

NON DIM					
4000K / CRI>90			3000K / CRI>90		
LED 33.2W / 3666lm / 900mA-DC			LED 33.2W / 3465lm / 900mA-DC		
+HONEYCOMB 90: LED 25W / 2974lm / 700mA-DC			+HONEYCOMB 90: LED 25W / 2811lm / 700mA-DC		
18°	24°	36°	18°	24°	36°
19921 9410 ◇	19921 9420 ◇	19921 9430 ◇	19921 9310 ◇	19921 9320 ◇	19921 9330 ◇
◇ B / W					
220-240V / 50-60Hz					
◇ 0,8 IP20					

SPYCO 90 ADM DIM 5

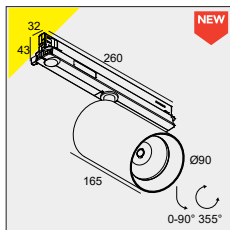

REQUIREMENTS
TRACK 3F DIM ON

DIMMING BY DALI					
4000K / CRI>90			3000K / CRI>90		
LED 33.2W / 3666lm / 900mA-DC			LED 33.2W / 3465lm / 900mA-DC		
+HONEYCOMB 90: LED 25W / 2974lm / 700mA-DC			+HONEYCOMB 90: LED 25W / 2811lm / 700mA-DC		
18°	24°	36°	18°	24°	36°
19921 9415 ◇	19921 9425 ◇	19921 9435 ◇	19921 9315 ◇	19921 9325 ◇	19921 9335 ◇
◇ B / W					
220-240V / 50-60Hz					
◇ 0,8 IP20					

ACCESSOIRES

SPYCO 70 HONEYCOMB

19922 0010 ◇

◇ B

0,1



SPYCO 90 HONEYCOMB

19922 0020 ◇

◇ B

0,1



TRACK 1F ON

COMPOSITION

- 1 TRACK 1F DIM ON
- 2 ENDCAP / SUPPLY / CORNERS

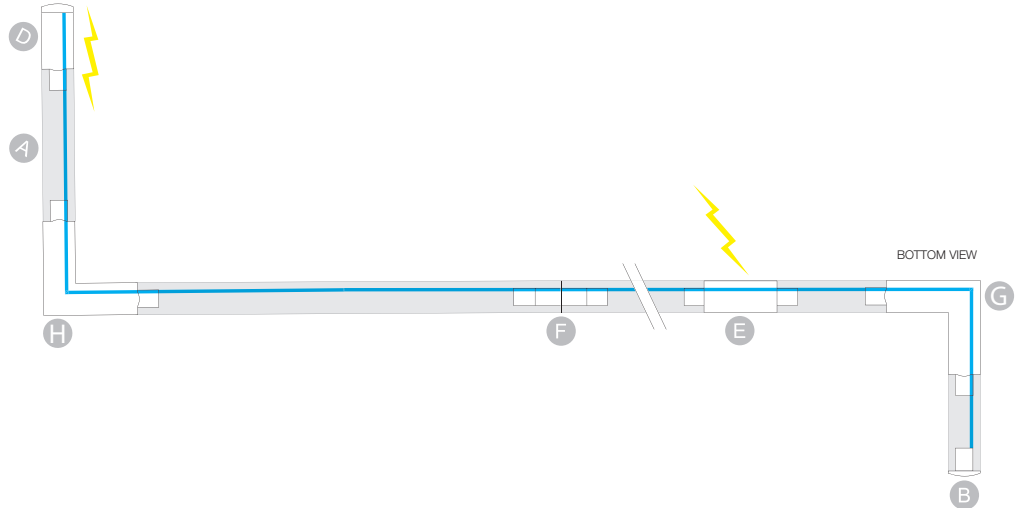

1 TRACK

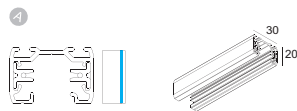

TRACK 1F ON 2m ◇
27600 0020 ◇
 ◇ = B / W (RAL 9010)
 110-240V / 50-60Hz / 1F
 ◇ IP20
 10

TRACK 1F ON 3m ◇
27600 0030 ◇
 ◇ = B / W (RAL 9010)
 110-240V / 50-60Hz / 1F
 ◇ IP20
 1,4

2 ENDCAP / SUPPLY / CORNERS



TRACK 1F ON END CAP ◇
27600 0410 ◇
 ◇ = B / W (RAL 9010)
 0,1

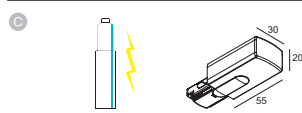

TRACK 1F ON END SUPPLY 11 ◇
27600 0110 ◇
 ◇ = B / W (RAL 9010)
 110-240V / 50-60Hz
 ◇ 0,1 IP20

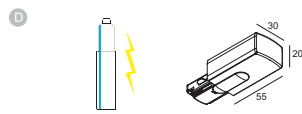

TRACK 1F ON END SUPPLY 12 ◇
27600 0120 ◇
 ◇ = B / W (RAL 9010)
 110-240V / 50-60Hz
 ◇ 0,1 IP20

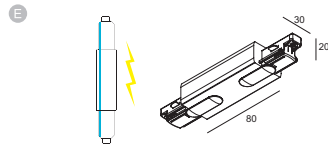

TRACK 1F ON MIDDLE SUPPLY ◇
27600 0140 ◇
 ◇ = B / W (RAL 9010)
 110-240V / 50-60Hz
 ◇ 0,1 IP20



TRACK 1F ON CORNER 180° ◇
27600 0210 ◇
 ◇ = B / W (RAL 9010)
 110-240V / 50-60Hz
 ◇ 0,1 IP20

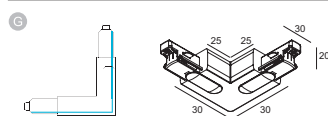

TRACK 1F ON CORNER 90° IN ◇
27600 0340 ◇
 ◇ = B / W (RAL 9010)
 ◇ 0,1 IP20

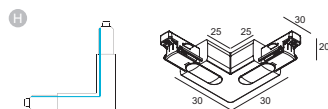

TRACK 1F ON CORNER 90° OUT ◇
27600 0350 ◇
 ◇ = B / W (RAL 9010)
 ◇ 0,1 IP20

SPYCO ADM1F

INTERIOR



SPYCO HI ADM1F B

ACCESSOIRES

SPY TUBE S
414 02 00 ◊
 ◊ B / W / MMAT
 [0,1]



SPYCO AC ADM1F DIM8

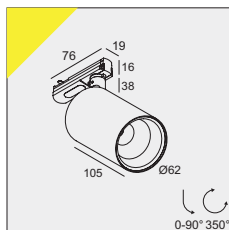

REQUIREMENTS
 TRACK 1F ON
ACCESSORIES
 SPY TUBE S

3000K / CRI>90	2700K / CRI>90
LED 8W / 630lm	LED 8W / 597lm
33°	
MAINS DIMMING (FE)	
27601 9328 ◊	27601 9228 ◊
◊ B / W (incl. SPY TUBE S)	
230V / 50-60Hz	
◊ [0,3] IP20	

SPYCO HI ADM1F

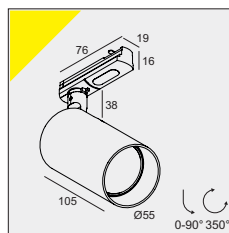

REQUIREMENTS
 TRACK 1F ON

QPAR51 max.20W
28318 0000 ◊
◊ B / W
100-240V / 50-60Hz
◊ [1,9] IP20

TOUPE

INTERIOR



TOUPE C AC DIM8 W + TOUPE SHADE M

REQUIREMENTS

TOUPE SHADE S

28700 0010

◇ B / W

0,3



TOUPE SHADE M

28700 0030

◇ B / W

1,0

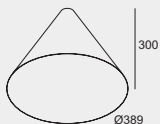

TOUPE SHADE L

28700 0020

◇ B / W

2,3

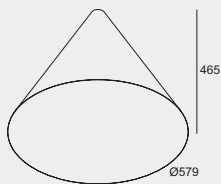

OPTIONS

LED FILAMENT LAMPS E27

A60 E27 6W 2700K ●
21024 0120

CRI>80 / 670lm / 6W
NON DIMMABLE
220-240V / 50-60Hz

0,1 IP20



A60 E27 6W 2200K ● - MIST
21024 0130

CRI>90 / 500lm / 6W
MAINS DIMMING (FE)
220-240V / 50-60Hz

0,1 IP20



CABLE CLAMP

15229 0010

◇ B

0,1



TOUPE C AC DIM8

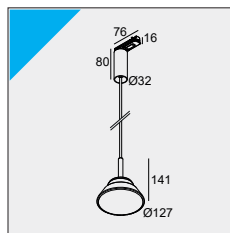

REQUIREMENTS

TOUPE SHADE S / M / L
TRACK 1F ON

OPTIONS

CABLE CLAMP

3000K / CRI>90	2700K / CRI>90
8W / 630lm	8W / 597lm
MAINS DIMMING (FE)	
100062 9308 ◇	100062 9208 ◇
◇ B / W	
230V / 50-60Hz	
INCL.1 x CABLE 3 x 0.75mm ² 1.6m	

◇ 0,6 IP20

TOUPE C E27

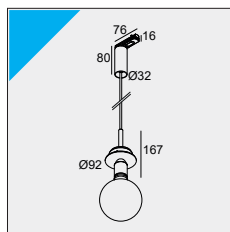

REQUIREMENTS

TOUPE SHADE M / L
TRACK 1F ON

OPTIONS

CABLE CLAMP
LED FILAMENT LAMP E27

1 x A60 max.20W
100064 0000 ◇
◇ B / W
E27 / 100-240V / 50-60Hz
INCL.1 x CABLE 3 x 0.75mm ² 1.6m

◇ 0,6 IP20

VARO X

EXTERIOR



VARO X

DEEP VARO X



DEEP VARO X W

REQUIREMENTS

CONTROL GEAR FULL INFO PAG 80-81

LED PS 350mA / 15W

300 90 91

INPUT 110-240V / 50-60Hz

OUTPUT 350mA / 15W / 2-41V-DC

0,2 IP20

min.40

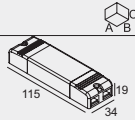

LED PS MULTI-POWER / 10W DIM8

21012 0258

INPUT 220-240V / 50-60Hz

OUTPUT 350mA / 10W / 16-29V-DC

FE 0,1 IP20

min.50

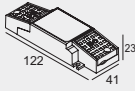

LED PS MULTI-POWER / 15W DIM8

21012 0268

INPUT 220-240V / 50-60Hz

OUTPUT 350mA / 14.7W / 26-42V-DC

FE 0,2 IP20

min.50

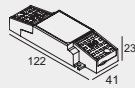

LED PS MULTI-POWER DIM5

300 90 125

INPUT 110-240V / 50-60Hz

OUTPUT 350mA / 15W / 43V-DC

DALI 0,1 IP20

min.55



LED PS MULTI-POWER DIM7

300 90 124

INPUT 110-240V / 50-60Hz

OUTPUT 350mA / 15W / 43V-DC

1-10V PUSH 0,1 IP20

min.55



			#LED [H]
	NON DIMMABLE	300 90 91	max.2(1)
	DIM 8	21012 0258	1
		21012 0268	2
	DIM 5	300 90 125	max.2
	DIM 7	300 90 124	max.2

VARO X

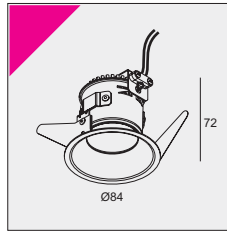

76 x 85 / min.5

REQUIREMENT

LED POWER SUPPLY 350mA-DC

3000K / CRI>90	2700K / CRI>90
LED [H] 7.1W / 812lm / 350mA	LED [H] 7.1W / 779lm / 350mA
36°	
21919 9320 ◊	21919 9220 ◊
◊ B / W	
◊ 0,3 IP44	

DEEP VARO X

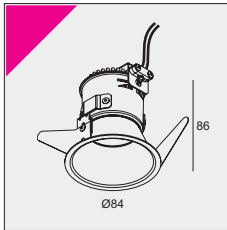

76 x 100 / min.5

REQUIREMENT

LED POWER SUPPLY 350mA-DC

3000K / CRI>90	2700K / CRI>90
LED [H] 7.1W / 812lm / 350mA	LED [H] 7.1W / 779lm / 350mA
36°	
21928 9320 ◊	21928 9220 ◊
◊ B / W	
◊ 0,3 IP44	

QOBY X

EXTERIOR



QOBY X R DIM8 B



QOBY X R DIM8 W

QOBY X R DIM8

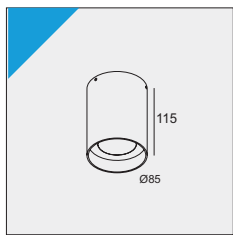

3000K / CRI>90	2700K / CRI>90
10.4W / 1128lm / 500mA	10.4W / 1083lm / 500mA
33°	
MAINS DIMMING (FE)	
19122 9338 ◇	19122 9238 ◇
◇ B / W	
220-240V / 50-60Hz	

◇ 0.6 IP44

MONO II

EXTERIOR



MONO II B



MONO II DOWN-UP B

MONO II

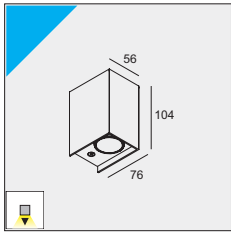

3000K / CRI>90
7.1W / 812lm / 350mA
223 13 811 930 ◇
◇ A / N
220-240V / 50-60Hz
◇ 0,4 IP54

MONO II DOWN-UP

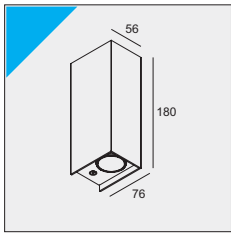

3000K / CRI>90
2 x 7.1W / 812lm / 350mA
223 53 812 930 ◇
◇ A / N
100-240V / 50-60Hz
□ 0,7 IP54

FOX

EXTERIOR



FOX B



FOX W B



FOX W DOWN-UP B

OPTIONS

IP68 CONNECTOR 3P
216 12 02

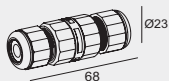

FOX

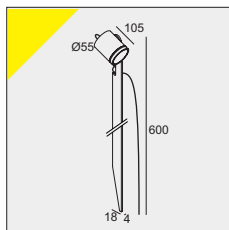

OPTIONS
IP68 CONNECTOR 3P ▶ 216 12 02

3000K / CRI>80
8W / 720lm
35°
25711 8320 ◇
◇ N
220-240V / 50-60Hz
INCL.1 x CABLE H05 RN-F 3 x 1mm ² 2m
ⓘ 0,6 IP65

FOX W

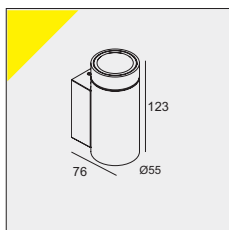

FOX W DOWN-UP

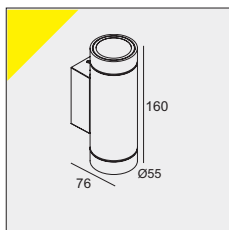

3000K / CRI>80
8W / 720lm
35°
25712 8320 ◇
◇ A / N
220-240V / 50-60Hz
ⓘ 0,6 IP65

3000K / CRI>80
2 x 8W / 720lm
35°
25713 8320 ◇
◇ A / N
220-240V / 50-60Hz
ⓘ 0,8 IP65

TIMON

EXTERIOR

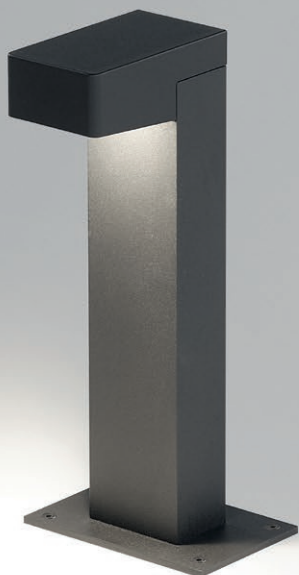

TIMON 40 B



TIMON 60 B

OPTIONS

PIN 19
15222 0030
 0,8

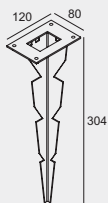

TIMON 25

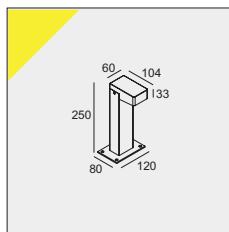

OPTIONS
 PIN 19

3000K / CRI>80
LED 8W / 720lm
27511 8300 ◇
◇ N
220-240V / 50-60Hz
INCL. 1 x CABLE H05 RN-F 3 x 1mm ² 2m INCL. 1x IP68 CONNECTOR 3P
◇ 1,0 IP55

TIMON 40

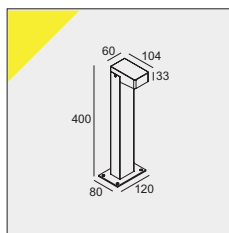

OPTIONS
 PIN 19

3000K / CRI>80
LED 8W / 720lm
27512 8300 ◇
◇ N
220-240V / 50-60Hz
INCL. 1 x CABLE H05 RN-F 3 x 1mm ² 2m INCL. 1x IP68 CONNECTOR 3P
◇ 1,3 IP55

TIMON 60

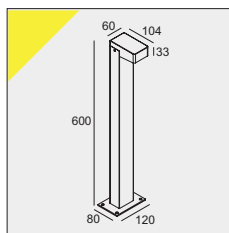

OPTIONS
 PIN 19

3000K / CRI>80
LED 8W / 720lm
27513 8300 ◇
◇ N
220-240V / 50-60Hz
INCL. 1 x CABLE H05 RN-F 3 x 1mm ² 2m INCL. 1x IP68 CONNECTOR 3P
◇ 1,6 IP55

TECHNICAL

DO'S & DON'TS

CONNECTION

CORRECT CONNECTION: SERIAL CONNECTION

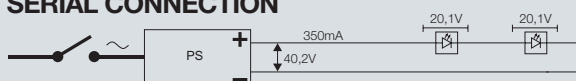

WRONG CONNECTION: PARALLEL CONNECTION

Depending on the number of fixtures the LED modules will function at half (2 LED's) one third (3 LED's) the luminous intensity. Moreover, due to different forward voltages the current will not split in equal part.

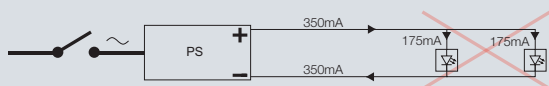

WRONG CONNECTION: TESTING OF LED MODULES ON SWITCHED ON POWER SUPPLY

Risk for an output voltage that exceeds the max for the LED.
A power supply that is switched on has max output on the secondary side (eg. 49V).
The LED in eg. a VARO is 7W works at 350mA and 20.1V.
49V is far too high for the VARO >> LED will be damaged.

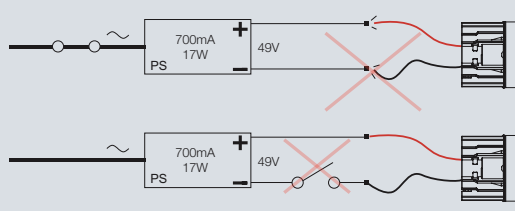

CURRENT CONTROLLED

DIMMABLE LED POWER SUPPLY - INSTALLATION SCHEME

- DIM1** 1-10V
- DIM5** DALI
- DIM7** 1-10V + SWITCH DIM
- DIM8** FALLING EDGE DIMMING

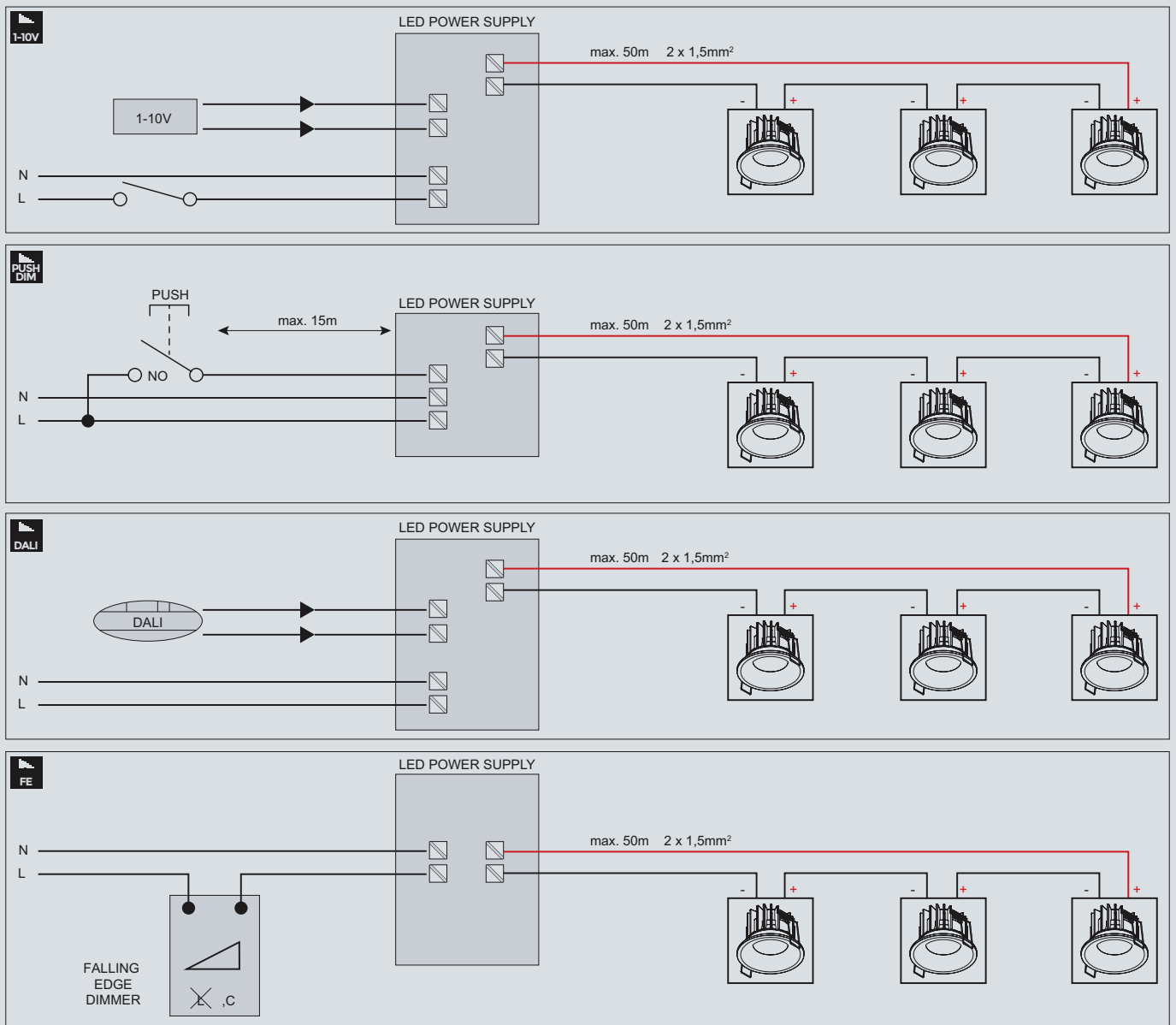

ALL DIAGRAMS ARE TYPICAL. PLEASE CHECK MAXIMUM POWER OF EACH INDIVIDUAL DEVICE FOR PRACTICAL USE.

TERMS & CONDITIONS

For all additional information, please visit deltalight.com

All information in this catalogue is provided for information purposes only and Delta Light® NV makes no representations about the accuracy or completeness of the information in this catalogue. Delta Light® NV may, in its sole discretion, revise the information and technical data contained herein at any time without notice. The catalogue does not contain any guarantee on the Delta Light® NV products nor any warranty of merchantability or fitness for a particular purpose or use. All Delta Light® products are supplied without lamps and any lamp data is given as a mere example.

The general terms & conditions of Delta Light® NV shall be applicable on each sale of a Delta Light® product. Any trademarks, texts, images, graphics, designs and other information in this catalogue are the sole property and subject to the intellectual property rights of Delta Light® NV and may not be copied, modified or used for any purpose without Delta Light®'s prior written consent.

